

## DIRECTIONS

### From Utrecht

From the A2, go in the direction of Schiphol (Ring-Zuid Amsterdam). Follow the signs for Schiphol [A10 Zuid] and then Leeuwarden Zaanstad [A10 Ring-West]. On the A10 take exit S102 to IJmuiden. Turn left onto Basisweg. At the second intersection, go right onto the Radarweg and there you can find your destination on the left.

### From The Hague

On the A4 follow in the direction Amsterdam Nieuw-West. Keep to the right for the A5 towards Haarlem and continue on the A5 to Amsterdam. Take exit 3 Amsterdam Westpoort. At the exit, turn left, then right at the next intersection onto Noordzeeweg. At the next intersection turn right onto Basisweg / S102. At the second intersection turn left onto Radarweg and after about 800 meters you will find your destination on the left.

### From Amersfoort

On the A1 at junction Watergraafsmeer choose Rotterdam Schiphol (A10 Ring-Oost), then Schiphol (A10 Ring-Zuid). Then continue to Leeuwarden Zaanstad (A10 Ring-West). On the A10 take exit S102 to IJmuiden. Turn left onto Basisweg. At the second intersection, turn right onto Radarweg and there you will find your destination on the left.

### From Zaandam / Alkmaar

On the A9 turn towards Velsen IJmuiden. Turn off at exit N8 / N203 for direction Zaandam / Amsterdam. Turn left onto the N203 to Zaanstad / Amsterdam. Continue on the Provincialeweg N8 then take the A8 to Amsterdam. A8 runs into A10. Go through the Coentunnel and take the first exit, S101, direction Amsterdam-Hemhavens, onto the Nieuwe Hemweg. At the first crossing turn right onto Kabelweg, immediately right again, onto Westhavenweg. Then at the second opportunity, turn left onto Radarweg. You will find your destination after about 800 metres on the right.

After the Coentunnel you can also use exit S102. In that case turn right, onto Basisweg, at the second junction right again, onto Radarweg and find your destination on the left.

### Public transport

From the front of Amsterdam Sloterdijk railway station it takes about 10 minutes on foot to our office. From the station turn right, this is the Radarweg. Cross the Basisweg and continue along Radarweg. You will find our office after some 800 m on your left.

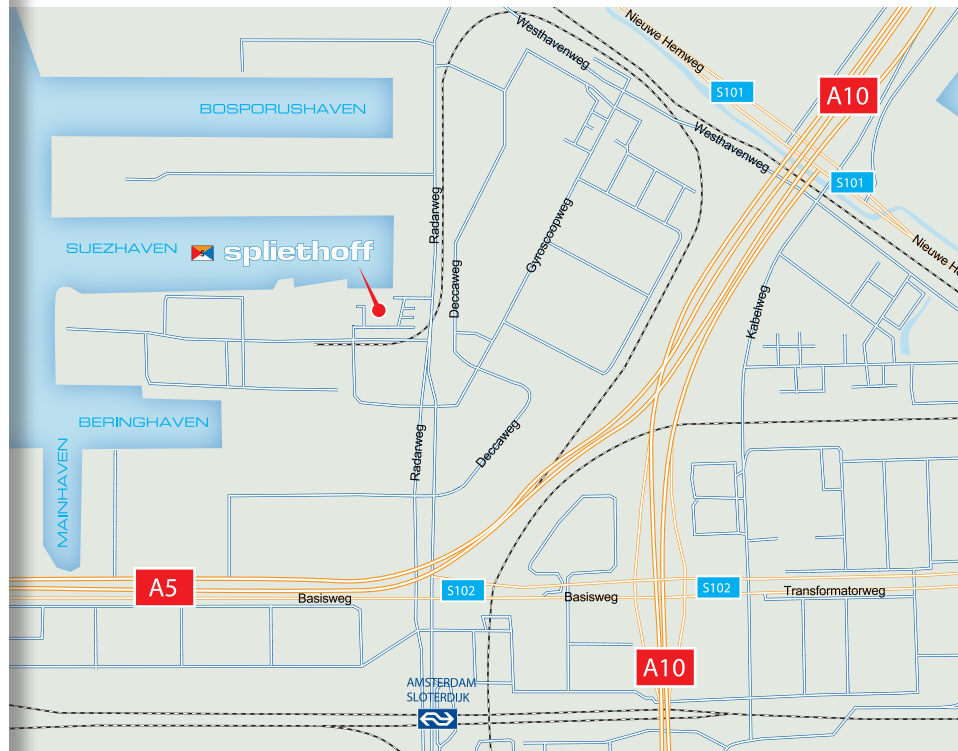
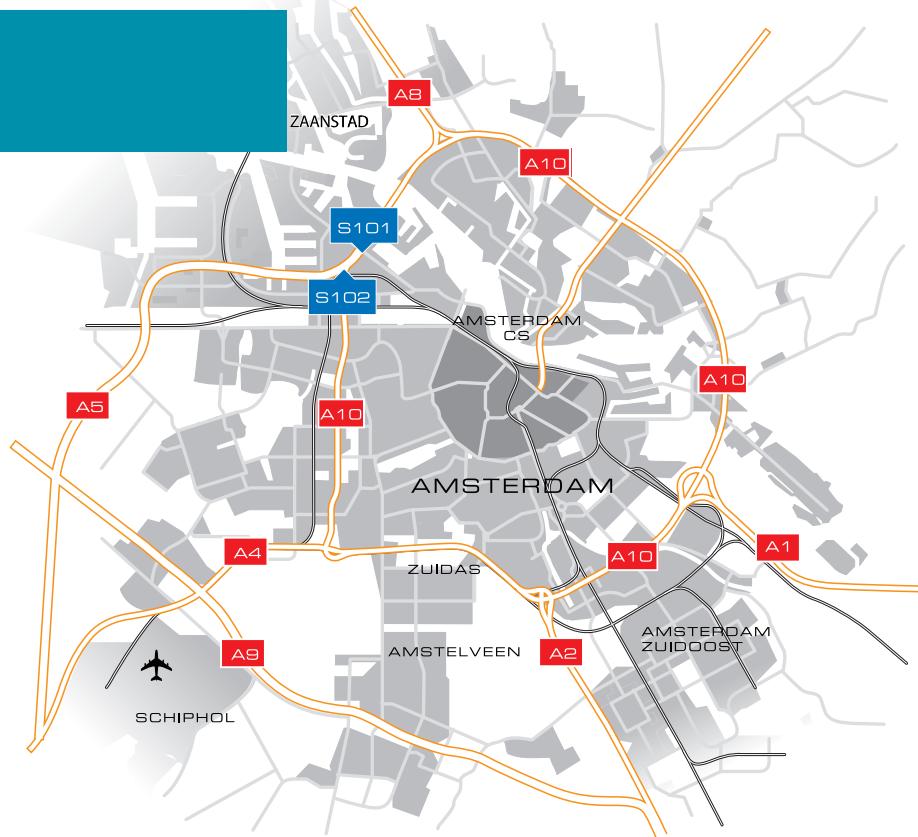

SPLIETHOFF

Radarweg 36, 1042 AA Amsterdam (Havennummer 4033)

T: +31 20 4488 400

E: amsterdam@spliethoff.com

I: www.spliethoff.com